

ACSF-306-FL

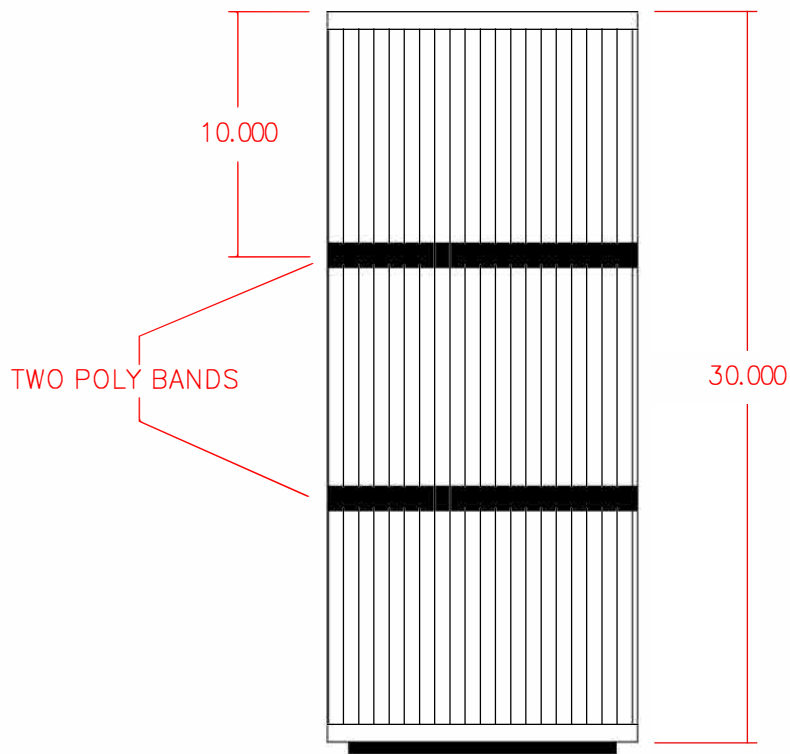
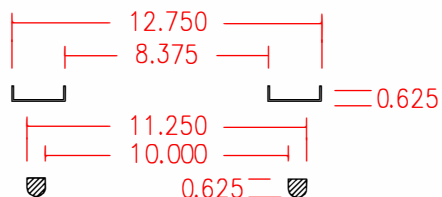
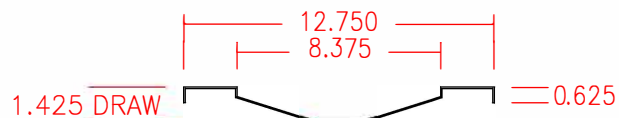

CONSTRUCTION:

ELECTROPLATED GALVANIZED CLOSED END CAP NO BOLT HOLE
ELECTROPLATED GALVANIZED OPEN END CAP
2 NYLON BANDS APPLIED TO OUTSIDE OF PLEAT PACK
G- 90 GALVANIZED EXPANDED METAL INNER CORE
240 SQUARE FEET ULTRA-LIFE FLAME RETARDANT MEDIA
EPDM RUBBER SEALING GASKET APPLIED TO ONE OPEN END CAP
URETHANE SEALANT APPLIED TO BOTH ENDS
HOT MELT ADHESIVE BEAD APPLIED OUTSIDE ONLY
PACKAGED ONE PER CARTON
WEIGHT: 18 POUNDS

EFFICIENCY: (PER ASHRAE 52.2- 1999)

TEST FLOW RATE: 750 CFM
INITIAL RESISTANCE: 0.69 INCHES W.G.
FINAL RESISTANCE: 4.00 INCHES W.G.
E1 (%) COMPOSITE MINIMUM AVERAGE EFFICIENCY 0.30 - 1.00 MICRON: 85
E2 (%) COMPOSITE MINIMUM AVERAGE EFFICIENCY 1.0 - 3.0 MICRON: 90
E3 (%) COMPOSITE MINIMUM AVERAGE EFFICIENCY 3.0 - 10.0 MICRON: 95
MINIMUM EFFICIENCY REPORTING VALUE: MERV 15 @ 750 CFM

MEDIA:

ULTRA-LIFE MEDIA IS A DUAL LAYER COMPOSITION DESIGNED TO OFFER HIGH INITIAL EFFICIENCY. THE SURFACE LOADING CHARACTERISTICS OF THE NANO FIBERS ALLOW EXCELLENT RELEASE CAPACITY TO PROMOTE LONG LIFE NECESSARY IN PULSE COLLECTOR APPLICATIONS.